

Welcome to Williamston Spring Dressage



April 9, 2019

Ride times will be posted on the show website by Tuesday, April 9th.

Stall assignments will be posted on www.rosinburg-events.com by Thursday, April 11th. They will also be posted at Barn F on the Show Grounds by 9:00 AM on Friday, April 12th. Bedding will be in the stalls when you arrive. The price of **extra shavings** is: **\$9.00** per bag. Please email Dianne Boyd with orders for extra shavings by Wednesday, if you want them in your stall when you arrive.

The **show office** will be located in a large white trailer just outside the **East Arena**. **Office hours:** Noon-7pm Friday, 7am-7pm Saturday, 7:00 am-1 hour after show ends on Sunday. **Competitor packets will be available and rings will be open at 12:00 noon on Friday. Chips and bottled water available at check-in on Friday** compliments of **Mary Phelps (Markel Insurance)**.

Stop by the show office each morning for **hot beverages and pastries** generously sponsored by **Encore Sporthorse and Susie Wiedman**.

On Saturday evening, everyone is invited to the **Competitor's party** near the show office at the East Complex. We'll have wine, beer, other beverages and hors d'oeuvres. The party is sponsored by **Martin County Tourism Development Authority (MCTDA)**. It will start at the end of classes on Saturday – approximately 5:00 pm.

On Sunday, enjoy **Ice Cream and Cookies**, generously sponsored by **EDCTSA**, in the show office.

The N.C. Dept. of Agriculture requires that a copy of a current **NEGATIVE COGGINS** test be available to the State Veterinarian's office for each horse entering the facility. Exhibitors **MUST post a copy of the Coggins on the horse's stall door or at your trailer** if you are not stabled. Any equine without a negative Coggins test will immediately be quarantined back to its point of origin. **NO** horses (including non-competing horses) will be permitted on the grounds reserved for this competition unless they have registered prior to arrival with the secretary and submitted a current negative Coggins test. **Also, remember to bring documentation of your horse's Equine Influenza Virus and Equine Herpes Virus (Rhino-pneumonitis) vaccinations within 6 months of the show.**

For those who are driving and using **Mapquest** or **GPS** systems for directions to the SBMEAC, **the physical address is:** 2630 Prison Camp Road, Williamston N.C. 27892. GPS Coordinates: N 35° 49.205' W 077° 06.672'

Day parking is permitted near the East Complex. *Please note that trailers CANNOT be parked around any barns.* Another small local show for H/Js will be using the rest of the facility on Thursday through Sunday, and will be using some of the other barns. **All horses for the WSD show will be stabled in Barn F.**

Braiding and nightwatch services will be provided by **Kat Parkinson** (336-432-1234 or pnwandb@hotmail.com).

The **farrier on call** is Jarrett Privette (919) 714-2170. The **veterinarian on call** is Karen Bulluck, DVM (252) 883-1597.

Exhibitors are advised to keep valuables secure as thefts are common at this facility.

Golf carts Contact Beaverdam Golf Carts at (252) 799-1394 \$50/day for two-seat and \$70/day for four-seat carts. Payment at delivery by cash or check; no credit cards. See WSD "Competitor Info" on Competitor page of website FMI.

To arrange **photography** or **videography**, contact **John Snyder** with **High Time Photography**. Phone or text John at 336-671-4446 or email at hightimephotography@gmail.com prior to or during the show to sign up. There is no cost or obligation to sign up for still photography. You must sign up for videos prior to your ride. Videos are done on first come basis. The website is: www.hightimephotos.com.

M&M Tack Shop will be on the grounds during the show. Be sure to contact them before the show if you have any special needs.

For directions and additional show information, visit the show website: www.rosinburg-events.com

Other information:

- ◆ **High Score awards:** sponsored by Foxden Equine, GumBits, Practical Horseman, Pierre Renard, High Time Photography and others.
- ◆ **First-place class/division awards** and **ProAm Team Challenge awards** are generously sponsored by M&M Tack Shop.
- ◆ **Special awards** will be presented at the competitor's party on Saturday and after the show on Sunday.
- ◆ **SIGN UP** for the **Trainers Award, Pro Am Team Challenge, Newcomer** and **Groom** award when you check in at the show office!
- ◆ **Info on special breed awards will be sent separately. Bring your registry information to qualify for these awards.**

HEADGEAR RULE FOR DRESSAGE

From the time horses are officially admitted to the competition grounds by competition management, anyone mounted on a horse at any time on the competition grounds, including non-competing riders, riders on non-competing horses, and those competing in all classes and tests, including Para-Equestrian tests, must wear protective headgear.

Note that a new link has been added to the website to check CURRENT ride times during the show.

We look forward to seeing you this weekend in Williamston!

Janine and Dianne

Janine's cell: 919-602-6203; e-mail: JEMRPH@aol.com;

Dianne's cell: 703-850-9704; e-mail: greyhorse11@gmail.com

RESULTS are posted www.rosinburg-events.com and will be updated frequently during the show. You can check results by class and by rider, and you may also check for scratches. Results may also be accessed directly through <http://www.foxvillage.com/>

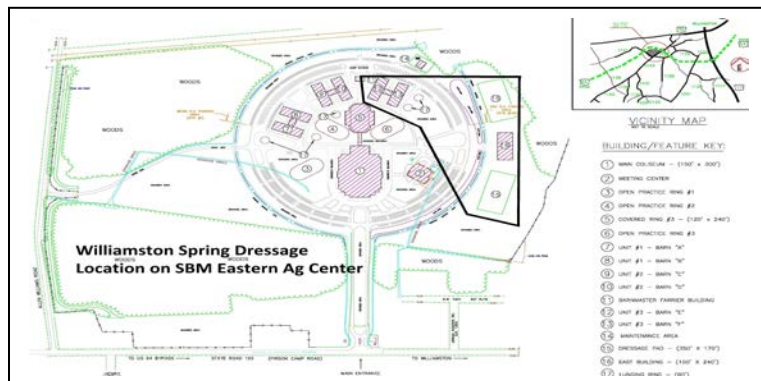

Because this is a USEF/USDF licensed Dressage Competition, horses entered in WSD may be exercised and ridden only in areas designated as part of this competition and outlined in this map. You may not ride in the covered ring or the main coliseum!!