



**APRIL 16-17, 2016**

# **Williamston Spring Dressage**

**Senator Bob Martin Eastern Agricultural Center - East Complex  
Williamston, NC**

*Official Qualifying Competition for the 2016 Adequan FEI North American Junior and Young Rider Championships presented by Gotham North; the 2016 USEF Pony Rider Dressage National Championship; 2016 AGCO/USEF Junior and Young Rider Dressage National Championships; and the 2016 USEF Young Adult 'Brentina Cup' Dressage National Championship presented by Dressage Today. Official Qualifying Competition for the 2016 Markel/USEF Young and Developing Horse Dressage Championships*

## **MANAGER**

Janine Malone  
Ph: 919-269-7307  
Cell at show: 919-602-6203  
[jemrph@aol.com](mailto:jemrph@aol.com)

## **SECRETARY**

Dianne Boyd  
18782 Harmony Church Road  
Leesburg, VA 20175  
Ph: 703-777-4846  
[greyhorse11@gmail.com](mailto:greyhorse11@gmail.com)  
Show Phone: 703-850-9704, 919-602-6203  
East Complex Day Ph (Fri-Sun): 252-799-4046

**WEBSITE:** [www.rosinburg-events.com](http://www.rosinburg-events.com)

## **SATURDAY, April 16, 2016**

10. \*Opportunity USDF Introductory Test A
11. \*Opportunity USDF Introductory Test B
12. \*USDF Introductory Test C
13. \*Opportunity Training Level Test I
14. \*Opportunity Training Level Test 2
101. Training Level Test 1
102. Training Level Test 2
103. Training Level Test 3
111. First Level Test 1
112. First Level Test 2
113. First Level Test 3
121. Second Level Test 1
122. Second Level Test 2
123. Second Level Test 3
131. Third Level Test 1
132. Third Level Test 2
133. Third Level Test 3
141. Fourth Level Test 1
142. Fourth Level Test 2
143. Fourth Level Test 3
151. FEI Pony Team Test
152. FEI Junior Team Test
153. FEI Young Rider Team Test
154. + USEF & FEI Young Horse Test of Choice
155. USEF Developing Prix St. Georges Test (2012 ed.)
156. USEF Developing Grand Prix Test (2012 ed.)
161. FEI Prix St. Georges
162. FEI Intermediaire I
163. FEI Intermediaire B
164. FEI Intermediaire II
165. FEI Grand Prix
166. + FEI Level or Equivalent Test of Choice (ex.YH & Freestyle)

## **JUDGES**

Jeanne McDonald (PA) "S"  
Jennifer Roth (NC) "S"  
Others TBA

## **TECHNICAL DELEGATE**

Lisa Rogers (NC) "R"

## **VETERINARIAN ON CALL**

Eastern Equine Vet Clinic  
Karen M. Bulluck DVM Pager: 252-551-9470

## **FARRIER ON CALL:**

TBA

**EMT:** Williamston Fire and Rescue – On Grounds

## **COMPETITION LICENSEE:**

Rosinburg Events, LLC, Janine Malone, Pres.

OPEN

OPEN, JR/YR & AA

OPEN

OPEN

OPEN

OPEN

OPEN & CBLM

OPEN, JR/YR, AA & 2016 GAIG/USDF Q

OPEN

OPEN & CBLM

OPEN, JR/YR, AA & 2016 GAIG/USDF Q

OPEN

OPEN, JR/YR, AA & CBLM

OPEN & 2016 GAIG/USDF Q

OPEN

OPEN & CBLM

OPEN, JR/YR, AA & 2016 GAIG/USDF Q

OPEN

OPEN, JR/YR, AA & CBLM

OPEN, JR/YR, AA & 2016 GAIG/USDF Q

USEF Q

NAJYRC/USEF Q & 2016 GAIG/USDF Q

NAJYRC/USEF Q & 2016 GAIG/USDF Q

OPEN

OPEN (7-9 YO HORSES)

OPEN (8-10 YO HORSES)

OPEN, Jr/YR, AA, CBLM, 2016 GAIG/USDF Q

OPEN, Jr/YR, AA, CBLM, 2016 GAIG/USDF Q

OPEN, Jr/YR, AA

OPEN, Jr/YR, AA, CBLM, 2016 GAIG/USDF Q

OPEN, Jr/YR, AA, CBLM, 2016 GAIG/USDF Q

OPEN, JR/YR & AA

171. +USEF Eventing Test of Choice A	OPEN
172. +USEF Eventing Test of Choice B	OPEN
173. Dressage Seat Equitation	JR/YR & AA
174. +FEI ParaEquestrian Test of Choice (ex. Freestyle)	PE
181. +#^USDF & FEI Freestyle Test of Choice	OPEN, CBLM & 2016 GAIG/USDF Q
182. + USEF Rider Test of Choice (2015 ed.)	OPEN, AA & JR/YR
183. +#^USDF Pas De Deux Test of Choice	OPEN & CBLM
184. USDF Materiale Cl. for 3, 4 & 5 YO Fillies/Mares	OPEN
185. USDF Materiale Cl. for 3, 4&5 YO Colts/Geldings/Stallions	OPEN
186. + Pony Test of Choice	OPEN

**SUNDAY, April 17, 2016**

20. *Opportunity USDF Introductory Test A	OPEN
21. *Opportunity USDF Introductory Test B	OPEN, JR/YR & AA
22. *USDF Introductory Test C	OPEN
23. *Opportunity Training Level Test I	OPEN
24. *Opportunity Training Level Test 2	OPEN
201. Training Level Test 1	OPEN
202. Training Level Test 2	OPEN & CBLM
203. Training Level Test 3	OPEN, JR/YR, AA & 2016 GAIG/USDF Q
211. First Level Test 1	OPEN
212. First Level Test 2	OPEN & CBLM
213. First Level Test 3	OPEN, JR/YR, AA & 2016 GAIG/USDF Q
221. Second Level Test 1	OPEN
222. Second Level Test 2	OPEN, JR/YR, AA & CBLM
223. Second Level Test 3	OPEN, Dover Medal & 2016 GAIG/USDF Q
231. Third Level Test 1	OPEN
232. Third Level Test 2	OPEN & CBLM
233. Third Level Test 3	OPEN, JR/YR, AA & 2016 GAIG/USDF Q
241. Fourth Level Test 1	OPEN
242. Fourth Level Test 2	OPEN, JR/YR, AA & CBLM
243. Fourth Level Test 3	OPEN, JR/YR, AA & 2016 GAIG/USDF Q
250. FEI Pony Individual Test	USEF Q
251. FEI Junior Individual Test	NAJYRC/USEF Q
252. FEI Young Rider Individual Test	NAJYRC/USEF Q
253. USEF Four-Year Old Test	Markel/USEF Q
254. FEI Five-Year-Old Final Test	Markel/USEF Q
255. FEI Six-Year-Old Final Test	Markel/USEF Q
256. + USEF & FEI Young Horse Test of Choice	OPEN
257. USEF Developing Prix St. Georges Test (2012 ed.)	USEF Q (7-9 YO HORSES)
258. USEF Developing Grand Prix Test (2012 ed.)	USEF Q (8-10 YO HORSES)
259. FEI Young Rider Grand Prix 16-25 Test	USEF Q
261. FEI Prix St. Georges	OPEN, Jr/YR, AA, CBLM, 2016 GAIG/USDF Q
262. FEI Intermediaire I	OPEN, Jr/YR, AA, CBLM, 2016 GAIG/USDF Q
263. FEI Intermediaire B	OPEN, Jr/YR, AA
264. FEI Intermediaire II	OPEN, Jr/YR, AA, CBLM, 2016 GAIG/USDF Q
265. FEI Grand Prix	OPEN, Jr/YR, AA, CBLM, 2016 GAIG/USDF Q
266. + FEI Level or Equivalent Test of Choice (ex.YH & Freestyle)	OPEN, JR/YR & AA
271. +USEF Eventing Test of Choice A	OPEN
272. +USEF Eventing Test of Choice B	OPEN
273. Dressage Seat Equitation	JR/YR & AA
274. +FEI ParaEquestrian Test of Choice (ex. Freestyle)	PE
275. #FEI Junior Freestyle Test	NAJYRC/USEF Q
276. #FEI Young Rider Freestyle Test	NAJYRC/USEF Q
281. +#^USDF & FEI Freestyle Test of Choice	OPEN, CBLM & 2016 GAIG/USDF Q
282. + USEF Rider Test of Choice (2015 ed.)	OPEN, AA & JR/YR
284. USDF Materiale Cl. for 3, 4 & 5 YO Fillies/Mares	OPEN
285. USDF Materiale Cl. for 3, 4 & 5 YO Colts/Geldings/Stallions	OPEN
286. + Pony Test of Choice	OPEN

+ State level and test on entry form.

# Music must be on good quality CD and must be presented to the announcer at least two hours before scheduled ride.

- ^ Freestyle entries (ex. FEI Jr/FEI YR & FEI Pony) must be accompanied by photocopy of test verifying eligibility (i.e. min. 60% in highest test of declared Freestyle level or any test of higher level from a USEF Licensed "open" Dressage division).
- \* **No USEF/USDF memberships or Horse ID required for Intro or Opportunity Classes. Opportunity classes also exempt from \$16 USEF fee.**

## **Williamston Spring Dressage - General Information**

### **DEFINITIONS/ELIGIBILITY:**

- **JR/YR** - Open to Juniors and Young Riders only; any rider is eligible until the end of the calendar year in which they reach the age of 21. Only riders ages 14-18 may ride FEI JR Tests. Only riders age 16-21 may ride FEI YR Tests. Only riders ages 12-16 may ride FEI Pony Tests.
- **AA** - Open to Adult Amateurs only; riders must compete as adults from the beginning of the calendar year in which they reach the age of 22. Must hold current USEF Amateur card, including Opportunity cl.
- **PE** - Riders must have a current USEF Dispensation Certificate which indicates their classification status to be eligible. All tests in Standard arena.
- **CBLM** - Colonel Bengt Ljungquist Memorial Championship qualifying class for 2016. Riders must be members of a participating organization at the time of the show to be eligible.
- **USEF QUAL** - Qualifying class for 2016 USEF National Championships
- **GAIG/USDF QUAL** - Qualifying class for 2016 GAIG/USDF Regional Dressage Championships. *Declare qualifying ride on entry form. Class fee plus additional \$10 fee must be paid prior to start of the class.*
- **Markel/USEF QUAL** - Qualifying class for 2016 Markel/USEF Young Horse Dressage Program
- **NAJYRC and USEF QUAL** - Qualifying class for 2016 FEI NAJYRC and AGCO/USEF National Junior and Young Rider Championships
- **OPPORTUNITY CLASSES** - No USEF/USDF memberships or Horse ID required for Opportunity classes if entered **ONLY** in Intro and/or Opportunity classes. Horses entered **only** in Opportunity classes are exempt from the \$16 USEF fee. However, horses entered in these classes are still subject to and must comply with all D&M rules and are subject to drug testing at the competition. Riders/horses are permitted to cross-enter into other recognized classes at this show.

### **LEVELS:**

All tests current editions. USEF Training-FEI Levels; USDF/FEI Freestyles (TR-FEI Levels), USDF Pas de Deux, Introductory & Materiale; USEF Rider Tests, USEF/FEI Young Horse, FEI ParaEquestrian, USEF/FEI Eventing & Dressage Seat Equitation.

### **AWARDS:**

- Prize and five ribbons in each Dressage class.
- Separate awards for Open, AAs and/or Jr/Yrs in any Dressage Open class with four or more in any division. All divisions (if specifically offered) pinned separately. Exception: Open, GAIG/USDF Qualifying & CBLM scored & pinned together.
- Dressage High Score awards at Training-Fourth Levels, FEI Levels combined (ex. Equitation, Materiale, Freestyle, Opportunity, Rider & YH tests).
- Trainers Award: Trainer plus min. two students. Awarded to team with highest average for both days combined. Sign-up in office by 10:00 am on first day competing. Additional details posted on sign-up form.
- USDF Dover Medal: Awarded to highest scoring eligible AA receiving at least 60% in Class #223.
- M&M Tack Pro Am Team Challenge. One professional plus 2-3 AAs, Jrs or YRs. Awarded on Saturday
- High Score AA: To highest scoring AA in any class ex. Equitation, Materiale, Freestyle, Intro, Rider & YH tests.
- High Score Jr/YR: To highest scoring Jr/YR in any class ex. Equitation, Materiale, Freestyle, Intro, Rider & YH tests.
- "Newcomer" Award: A special award for a rider competing in his/her first USEF/USDF Dressage Competition.
- Club High Score: To the highest scoring EDCTSA member in any class except Equitation, Materiale, Freestyle, Intro, Rider & YH tests.
- Pony Test of Choice: Entries in these classes will be eligible for 2016 National Dressage Pony Cup (NDPC) year-end awards.
- National Dressage Pony Cup Championship and High Point Awards: High Point award to the highest scoring pony in any class except Equitation, Materiale, Freestyle, Intro, Rider & YH tests. NDPC Championship ribbon to be sent from NDPC. Only ponies with valid USEF measurement certificates submitted to the show secretary will be eligible for either award. All eligible for NDPC year-end awards.
- TIP Awards: The Jockey Club Thoroughbred Incentive Program (T.I.P.) is offering a high score and reserve ribbons for Thoroughbreds. Eligible horses must provide T.I.P. numbers to the event secretary

with entry. For more information, visit [www.tjctip.com](http://www.tjctip.com). All classes count except Equitation, Materiale, Freestyle, Intro, Rider & YH tests.

- Dressage High Score Hanoverian: Sponsored by AHS. No AHS membership required. All levels eligible, excluding Intro, Equitation, Materiale, Freestyle, Rider & YH tests. Winner receives neck sash.
- "Born in the USA" Award: To highest scoring (not highest placing) horse foaled in U.S. Eligibility determined by breeder's address on horse's registration papers or other verification in writing. Excl. Equitation, Materiale, Freestyle, Intro, Rider & YH tests. Winner will receive a special award.
- Best Groom Award: Sign up in show office. Winner chosen by ring stewards on Saturday.
- Other special awards, including Best Seat and breed awards, to be announced in Official Program.

#### **ENTRY FEES:**

Intro, Opportunity, Materiale & Equitation	\$35
Training – Second, Eventing	\$45
Third – Fourth	\$50
Freestyle, Pas de Deux, YH (ex.USEF Q), ParaEquestrian	\$55
FEI & USEF Devel PSG/GP (ex. USEF Q)	\$60
NAJYRC & USEF Q (YH, Pony, JR, YR, Dev PSG & GP, Brentina)	\$65
GAIG/USDF Qualifying	Add \$10 to class fee
USEF Fee per horse (D&M \$8, USEF \$8)	\$16/horse
USEF Show Pass Fee	\$30 (for each NM rider, owner, trainer, coach)
USDF Non-Member Fee	\$25 (for each NM rider & owner)
Late Fee	\$30 (for entries <u>received</u> after April 2)
Non-Competing Horse Fee	\$30
Parking Fee (REQUIRED for non-stabled horses)	\$25/show day
Office Fee (non-refundable)	\$35 (for ea H/R combination)
Horse or Tack Stall (Fri-Sun)	\$115 (includes 2 bags initial bedding)
Double Horse Stall (Fri-Sun) <i><u>IF AVAILABLE</u></i>	\$230 (includes 4 bags initial bedding)
Extra Shavings	\$9/bag
RV hookup (electric/water – reservations req.)	\$30/night
NSF check charge	\$35
Class change fee (for changes after closing date/if schedule allows)	NO CHARGE!!

#### **ENTRY INFORMATION:**

- ***ALL FEES MUST BE PAID IN U.S. DOLLARS AND ENTRIES MUST BE RECEIVED BY CLOSING DATE! No processing fee for online entries.***
- ***Make check payable to Rosinburg Events LLC and mail to secretary with entry and negative Coggins (valid within 12 months of first competition day).***
- 2016 Entry form required. Entry form must be properly signed with original signatures; an adult (18 or older) must sign for JR riders and on trainer blank.
- ***Proof of membership must be included with entry form. Please provide the USEF/USDF Master Verification ([www.eqverification.org](http://www.eqverification.org)) although membership cards or photocopies of cards are still acceptable.*** Failure to provide proof of USEF and/or USDF membership will result in competitor being charged Show Pass or non-member fees.
- USEF and USDF membership numbers and horse registration numbers must be provided where required. Photocopied signatures not permitted. *Unless exempt:* Must provide verification of (1) 2016 USEF "competing" membership for rider, handler, owner, trainer, and coach or pay Show Pass fee; (2) 2016 USDF membership verification for rider (PM or GM) and owner (PM, GM or BM), or copy of nonmember ID card and pay Non-Member fee; and (3) USEF Recording, USDF Lifetime Registration or USDF HID #. Owners of horses without USDF registration or HID MUST complete application, submit breed registry papers (if horse is registered) and pay \$25 USDF HID fee upon arrival at competition in order to participate (except exempt Dressage classes).
- Adult Amateur entries must provide verification of their USEF Amateur status.
- Pony Rider, Junior and Young Rider entries must include birth date on entry form.
- Non-U.S. citizen participants must send proof, in English, of current membership in good standing from their own NF, a photocopy of their 2016 USEF membership card, or must pay the USEF Show Pass fee.
- Post entries accepted with Late Fee, if scheduling permits, or placed on wait list to fill scratches.
- Non-negotiable checks void entry and incur a \$35.00 charge. Entry will be placed on waiting list until a money order, certified check or cash is received.
- **Trainers:** Email your "Stable With" list and stall order to show sec'y at least seven days before show.
- Show office hours: Noon—7pm Friday, 7am—7pm Saturday, 7am—1 hour after show ends on Sunday.

### **NON-COMPETING HORSES:**

Must submit completed and signed Entry form to the Show Secretary, show proof of current Coggins, and pay \$30 N/C Horse fee plus \$35 Office fee. Parking or stabling fees are also required. USEF/USDF fees or Late fee NOT required.

### **MEMBERSHIP/REGISTRATION REQUIREMENTS FOR GAIG/USDF QUALIFYING CLASSES:**

Riders must be current USDF Participating members & USEF members (Junior, Senior or Life) in good standing. Horses must be USDF registered and USEF recorded. Horses with only an HID are not eligible. Owners must be current USDF Participating or Business members & USEF members (Junior, Senior or Life) in good standing.

### **MATERIALE CLASSES:**

Judged under saddle as a group at walk, trot and canter according to criteria listed on the "USDF Materiale Class" score sheet. Horses must be at least 36 months of age to participate.

### **PRO-AM TEAM CHALLENGE:**

- One Professional plus two - three Adult Amateurs, Juniors and/or Young Riders make up a Pro-Am Team. Any level may be ridden; levels may be combined. The three highest scores will be averaged to find the Team Score from the Saturday rides of all Team Members. (Intro, MFS, Materiale, Young Horse Tests, Rider tests and DSE scores will not be included.) Team members (Professionals, Amateurs, Juniors and Young Riders) are considered as a horse/rider combination – if a rider has more than one horse entered in the competition, he/she may ride on more than one team – each team must have unique horse/rider combinations.

- **Awards:** Special prizes for all members of 1st through 3rd placing Teams. All team members should be present at the Awards Ceremony to receive prizes. Ceremony will take place at competitors' party immediately after show on Saturday afternoon.

- **Entries:** *No GMO memberships required and NO EXTRA FEES!* Teams must be named with all team members indicated by 10:00 am Saturday. Competitors must sign up in show office.

### **REFUNDS:**

No refunds after closing date or after the start of the competition for any reason, including in the event of cancellation of classes due to severe weather or other emergency. GAIG/USDF Q fees refunded if request received before start of class until end of competition (unless applied to other indebtedness); otherwise will be paid to USDF. Refunds will be made before closing date less a \$35 fee.

### **ENTRY STATUS & TIMES:**

- Acknowledgement of entry showing status will be emailed (or mailed for competitors without email address) to each competitor. Include LEGIBLE email address with your entry. Please check for errors and notify the secretary immediately.

- Official times posted by noon on Friday at show office. Unofficial times posted on website approximately five days before show.

### **STABLING:**

Stabling in Barns E and F (see map – these are the two barns closest to the East Complex and dressage rings). Permanent 10 x 10 stalls with sliding doors in center aisle barns. Anyone requesting a double stall, if available, will be stabled in another barn. Facility will remove center partition for double stall (\$230 rate for weekend) if ordered by closing date; must indicate on entry form. Stalls \$35/\$80 per night for each additional night. Shavings available for purchase at show. Those wanting extra bedding at stalls upon arrival must pre-order through Secretary at least 24 hours prior to arrival. NOTE: SBMEAC requires that all bedding be purchased on-site. No outside bedding allowed. Each entry **MUST** include stabling or parking fee. **Upon arrival, an extra copy of the Coggins must be posted on sleeve of the stall door of each horse for examination by NC State Veterinarian's office inspector.**

### **ACCOMMODATIONS:**

Host hotel: **Holiday Inn Express (252-799-0100)**, (directly across from SBMEAC entrance), free hot breakfast, free wired & wireless internet, pets allowed, ask for horse show rate; Inn at Moratoc (252-792-3184), (5 miles from SBMEAC); Hampton Inn (252-809-1100), (5+ miles from SBMEAC). See complete hotel listing on show website. On-site RV hookups available at \$30/night; includes water/electric. Advance reservations are required; send fee with entry to show secretary.

### **DIRECTIONS:**

SBM Eastern Ag Center, 2900 NC Hwy 125 So., Williamston, NC 27892. Located just off US 64 (just 48 miles east of I-95). From US 64, take exit 512. Turn south, SBM Ag Center is 100 yards on right. TRAILERS, drive past mail entrance, take next right on Allen Williams Road (less than ¼ mil) for easier, direct stabling access.

## ARENAS:

Three outside 20 x 60 meter sand/crushed granite screenings all-weather competition arenas. One indoor warmup with composite footing. Outdoor warmup area with all-weather sand/crushed granite screenings or large grass area. All dressage classes in 20 x 60 meter arenas. Lungeing permitted only in designated lungeing rings. Riding and exercise is permitted only in rings/areas designated by this show (see map).

## HOSPITALITY:

Food on grounds (from start until end of classes) during show. Free competitor's party after show on Saturday. Hot beverages and muffins each morning. Dessert Social on Sunday.

## VENDORS

Vendor spaces are available near show office and rings. Must submit application to Manager. For vendor application go to [www.rosinburg-events.com](http://www.rosinburg-events.com). Outdoor space only. Must provide trailer or tent.

## OTHER:

- Management reserves the right to add, combine or divide classes, add or substitute judges, or make any changes required by circumstances.
- **If a competitor NO SHOWS their first class of the day, they may be considered a SCRATCH for the remainder of the day at show management's discretion.**
- **DOGS MUST BE ON LEASHES or otherwise restrained AT ALL TIMES WHILE ON SHOW GROUNDS (INCLUDING IN STABLE AREAS).** Owner may be fined. Individuals must not lead dogs on a leash while mounted. **Dog owners are solely responsible for any damages, claims, losses or actions resulting from their dogs' behaviors.** All pets must be leashed. **Dog owners failing to comply will be issued a Yellow warning card** and non-compliance may result in further USEF penalties.
- If ponies are entered in FEI Pony Test(s) or Pony TOC class, or wish to be eligible for dressage pony awards, and are in need of a USEF measurement card, an appointment for measuring **MUST** be made with management at least five days prior to the show. The official measurement session will be scheduled on Friday, April 15. Owners of ponies needing measurement will be charged a fee not to exceed \$100 to cover the fee charged by the official veterinarian required for the measurement.
- All emergency numbers will be posted in/outside the Secretary's office and in the barns.
- Veterinarian and farrier will be on call. EMT on grounds.
- Riders may substitute horses once they have entered only upon presentation of a Vet Certificate for the incapacitated horse, or a bill-of-sale, and only in classes in which the first horse was entered. The Secretary must be notified 24 hours before the class(es) take(s) place, and a new entry form must be completed.
- Anyone bringing non-competing horses must supply, prior to Closing Date, a current Coggins and a signed entry form before entering the show grounds.
- **Numbers must be worn at all times when a horse is being exercised or ridden.**
- In accordance with GR1301.7: Minors who do not have a valid driver's license which allows them to operate a motorized vehicle in the state in which they reside will not be permitted to operate a motorized vehicle of any kind, including, but not limited to, golf carts, motorcycles, scooters, or farm utility vehicles, on the competition grounds of licensed competitions. Minors who have a valid temporary license may operate the above described motorized vehicles as long as they are accompanied by an adult with a valid driver's license. **The parent(s), legal guardian(s), or individual who signs the entry blank as a parent or guardian of a minor operating a motorized vehicle in violation of this rule are solely responsible for any damages, claims, losses or actions resulting from that operation.** Violations of this rule will be cause for sanctions against the parent(s), guardian(s) and/or trainer(s) who are responsible for the child committing the offense. Penalties may include exclusion of the child, parent(s), guardian(s), and/or trainer(s) from the competition grounds for the remainder of the competition and charges being filed against any of the above individuals in accordance with Chapter 6. Wheelchairs and other mobility assistance devices for individuals with disabilities are exempt from this rule.
- Sharps containers are located in the center aisle of each barn. Per USEF rules, competition management may fine any individuals including trainers, owners, exhibitors, or their agents up to \$100 for improper disposal of needles or other sharp disposable instruments.
- *All owners and competitors are personally responsible for damages to third parties caused by themselves, their employees, their agents, or their horses. They are therefore strongly advised to take out third-party insurance providing full coverage for participation in equestrian events.*
- For current Great American/USDF Championship requirements, go to [www.usdf.org/competitions/competitions-championships/regionals/index.asp](http://www.usdf.org/competitions/competitions-championships/regionals/index.asp)
- For current CBLM Championship requirements, go to [www.cblm.org](http://www.cblm.org)
- For Dover Medal Program information, go to [www.usdf.org/awards/performance/adultmedalprogram.asp](http://www.usdf.org/awards/performance/adultmedalprogram.asp)
- **Golf Carts:** Available through advance reservations at \$50/day. Contact Contact Byron Unger at [ungerrnts@gmail.com](mailto:ungerrnts@gmail.com) or 919-337-7456. Limited number available, so don't wait until the last minute!

- **New USEF rule, effective 12.1.15:** Horses entering the grounds must be accompanied by documentation of Equine Influenza Virus and Equine Herpes Virus (Rhinopneumonitis) vaccinations within 6 months prior to entering the stables. Horses not in compliance with this rule may be required to leave the grounds upon request by Competition Management. (See GR845)

#### **USEF Membership Statement (GR901.9)**

Life, senior active and junior active members shall be eligible to participate in all classes at Regular Competitions, Eventing Competitions at the Preliminary Level or above and Combined Driving Competitions at the Advanced Level, Dressage, Reining and Vaulting Competitions and Endurance Rides. A nonmember may participate as a handler, rider, driver, owner, lessee, agent, coach or trainer at Regular Competitions, Eventing Competitions, Dressage Competitions, Reining Competitions and Combined Driving Competitions upon payment of a \$30 Show Pass fee. Participants in the following classes are exempted from the Requirements of this rule: 1) leadline; 2) exhibitions; 3) games and races; 4) classes for 4-H members; 5) walk trot and academy classes (academy classes are classes limited to horses used regularly in a lesson program); 6) USDF introductory level tests, pas de deux and quadrille classes; 7) NRHA Endorsed Reining Competitions. 8) Opportunity classes, 9) citizens of other nations who have proof, in English, of current membership in good standing of their own National Federation, 10) USEA beginner novice division; and 11) assistant handlers in Dressage Sport Horse Breeding classes.

#### **ATTENTION COMPETITORS –HEADGEAR RULE FOR DRESSAGE**

From the time horses are officially admitted to the competition grounds by competition management, anyone mounted on a horse at any time on the competition grounds, including non-competing riders, riders on non-competing horses, and those competing in all classes and tests, including Para-Equestrian tests, must wear protective headgear as defined by this rule and otherwise in compliance with GR801. Any rider violating this rule at any time must immediately be prohibited from further riding until such headgear is properly in place. Protective headgear is defined as a riding helmet which meets or exceeds ASTM (American Society for Testing and Materials)/SEI (Safety Equipment Institute) standards for equestrian use and carries the SEI tag. The harness must be secured and properly fitted.

#### **U.S. Equestrian Federation, Inc. Entry Agreement**

By entering a Federation-licensed Competition and signing this entry blank as the Owner, Lessee, Trainer, Manager, Agent, Coach, Driver, Rider, Handler, Vaultor or Longeur and on behalf of myself and my principals, representatives, employees and agents, I agree that I am subject to the Bylaws and Rules of The United States Equestrian Federation, Inc. (the "Federation") and the local rules of the competition.

I agree to be bound by the Bylaws and Rules of the Federation and of the competition. I will accept as final the decision of the Hearing Committee on any question arising under the Rules, and agree to release and hold harmless the competition, the Federation, their officials, directors and employees for any action taken under the Rules.

I represent that I am eligible to enter and/or participate under the Rules, and every horse I am entering is eligible as entered.

I also agree that as a condition of and in consideration of acceptance of entry, the Federation and/or the Competition may use or assign photographs, videos, audios, cable -casts, broadcasts, internet, film, new media or other likenesses of me and my horse taken during the course of the competition for the promotion, coverage or benefit of the competition, sport, or the Federation. Those likenesses shall not be used to advertise a product and they may not be used in such a way as to jeopardize amateur status.

I hereby expressly and irrevocably waive and release any rights in connection with such use, including any claim to compensation, invasion of privacy, right of publicity, or to misappropriation.

The construction and application of Federation rules are governed by the laws of the State of New York, and any action instituted against the Federation must be filed in New York State. See GR908.4.

## WARNING

Under North Carolina law, an equine activity sponsor or equine professional is not liable for an injury to or the death of a participant in equine activities resulting exclusively from the inherent risks of equine activities. Chapter 99E of the North Carolina General Statutes.

### Waiving Jackets before Competition and Modified Dress Code when Jackets are Waived

In locations with high average heat and humidity on the date of a competition, management can publish in their prize list that jackets will be waived for the duration of the competition. This waiver applies to all classes including FEI classes at National Competitions. However, competitors must wear protective headgear and a shirt with sleeves and collar, without neckwear, and without decoration except as described under DR120.14. T-shirts are not permitted. Members of the Armed Services or police units may wear summer uniforms.

### Modified Dress Code for Riders in Opportunity Classes

Riders in classes and tests at all levels in Level 1 Competitions, and riders in Opportunity classes in Level 2 and Level 3 Competitions, may compete wearing breeches and shirts of any color as permitted in DR120.8. Jackets or vests of any type are allowed but not required and neckwear may be worn only if the rider chooses to compete in a riding jacket. Boots and protective headgear are required as specified in DR120.1-6. USEF DR120.5. **ACCORDINGLY, JACKETS ARE NOT REQUIRED FOR ANY RIDERS IN OPPORTUNITY CLASSES AT THE WSD COMPETITION.**

### NEW USEF RULE: Fly Hoods now permitted for all classes (indoor and outdoor)

Fly hoods (ear covers) are permitted for all classes in order to protect horses from insects. The fly hoods should be discreet in color and design and should not cover the horse's eyes. After completion of the test, the rider or his representative is responsible for removing the fly hood to present to the designated ring steward for inspection to ensure that nothing prohibited has been added (for example, ear plugs. USEF DR121.7

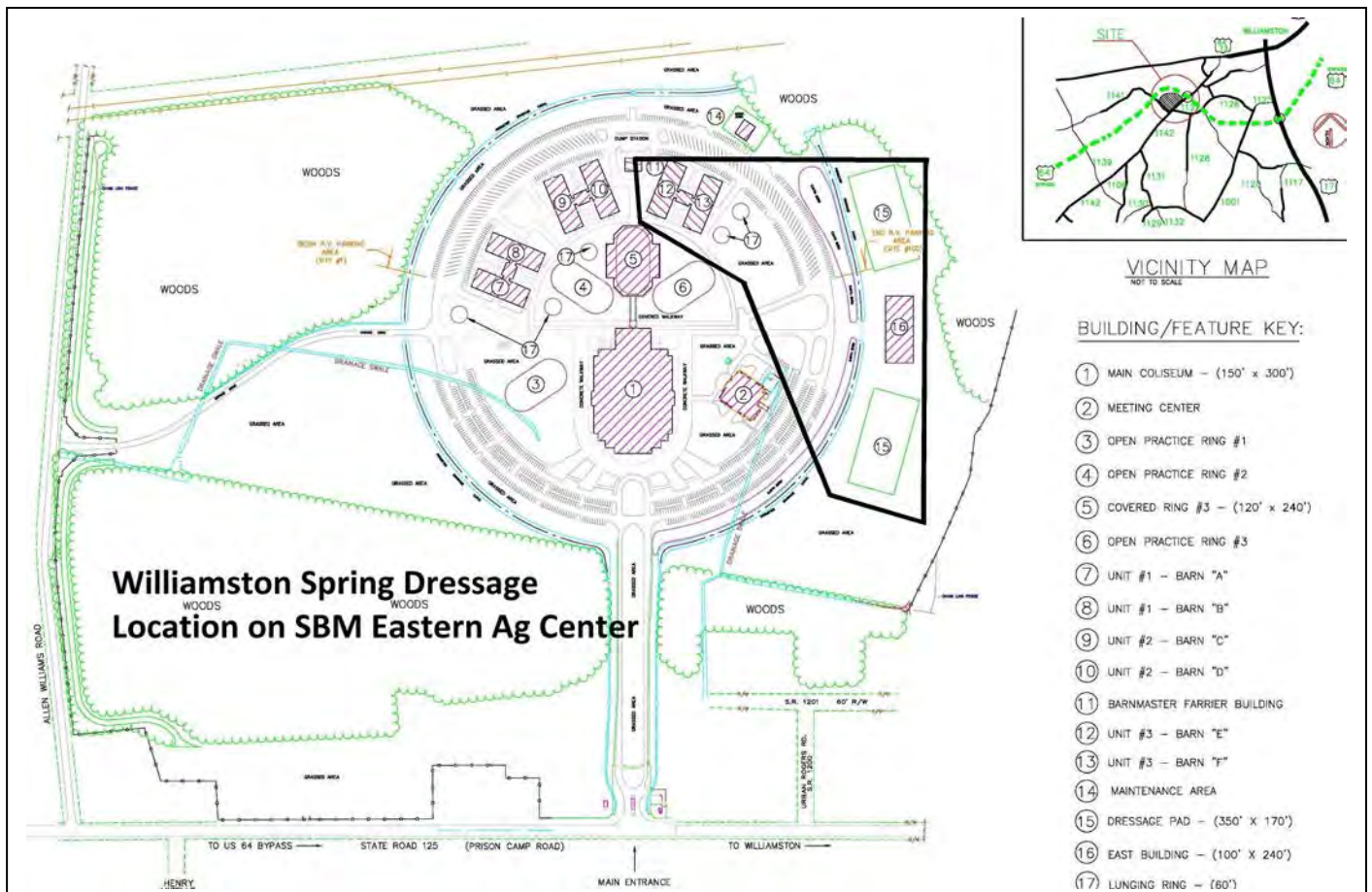



**EVERY CLASS OFFERED HEREIN WHICH IS COVERED BY THE RULES AND SPECIFICATIONS OF THE CURRENT USEF RULE BOOK AND WILL BE CONDUCTED AND JUDGED IN ACCORDANCE THEREWITH.**

**ATTENTION COMPETITORS**

Each competitor is responsible for supplying management with correct association numbers (USDF, USEF) for horse, owner, rider and trainer, before the day(s) of the competition. The scores of competitors who fail to supply correct numbers may not be counted toward national awards.

**ONLINE ENTRIES:**

Go to [www.rosinburg-events.com](http://www.rosinburg-events.com) to enter online via [horseshowoffice.com](http://horseshowoffice.com) and pay using PayPal or electronic check. Select the classes you wish to enter, GAIG/USDF qualifying fees and stabling and total your fees. You can either make secure payment through Paypal, or electronic check, or print the entry form and mail with your paper check. Either scan your Coggins and signature page and upload directly to [horseshowoffice.com](http://horseshowoffice.com) or send via email to the Secretary, or present your Coggins and sign entries upon arrival at the show. [Rosinburg Events, LLC covers all PayPal, credit card, electronic check, and online entry system fees.] **THERE ARE NO EXTRA FEES TO COMPETITORS FOR USING THIS SYSTEM.**



**Thoroughbred Incentive Program Awards**

**Eligibility** – Only Thoroughbreds that have been registered with The Jockey Club or a foreign Thoroughbred stud book recognized by The Jockey Club are eligible to participate in T.I.P. classes and awards. Riders and owners should obtain a T.I.P. number for all horse/rider combinations. T.I.P. number applications are done online at [www.tjctip.com](http://www.tjctip.com). **T.I.P. numbers must be provided to the horse show.**



## 2016 Great American Insurance Group/USDF Regional Dressage Championships

A single Regional Dressage Championship program organized by the United States Dressage Federation (USDF), and recognized by the United States Equestrian Federation, Inc. (USEF), will be held in each of the nine USDF regions. In addition, Alaska and Hawaii may each hold state championships if an official request from a Group Member Organization (GMO) is received by April 1 of the prior year. The Regional Championship Program Rules can be found on the USDF website at [www.usdf.org](http://www.usdf.org). Please refer to the 2016 USDF Member Guide for the comprehensive list of rules and requirements for this program.

### Membership/Registration Requirements for Qualifying and Championships

Rider:

- Must have a USDF Participating\* Membership (PM) at the time qualifying scores are earned and at the time of the championships.
- Must have a USEF membership (Junior Active, Senior Active, or Life) at the time the qualifying scores are earned and at the time of the championships.

Horse:

- Must have a USDF Lifetime Horse Registration (LHR) at the time qualifying scores are earned and at the time of the championships.
- Must have a USEF (Annual or Lifetime) Membership recorded at the time qualifying scores are earned and at the time of the championships.
- USDF horse registration and USEF horse/recording must be in the name(s) of the current owner(s) or lessee(s) of record.
- A horse is not required to have breed registry papers.

Owner:

- Must have a USDF membership (PM\* or Business Member (BM)) at the time the qualifying scores are earned and at the time of the championships.
- Must have a USEF membership (Junior Active, Senior Active, or Life) at the time qualifying scores are earned and at the time of the championships.

\* PMs are USDF members who join USDF directly. USDF Group Members (GM) are ineligible.

**Minimum Qualifying Scores.** One set of nationally-standardized qualifying scores has been established for all USEF/USDF Regional Championships, for levels through Grand Prix, in three divisions: open, adult amateur and junior/young rider. FEI Junior and FEI Young Rider classes have only one respective division. Freestyles have only open divisions.

The minimum percentages are as follows:

	OPEN	AA	JR/YR
Training Level (Test 3)	68%	63%	63%
First Level (Test 3)	66%	62%	62%
Second Level (Test 3)	64%	61%	61%
Third Level (Test 3)	62%	60%	60%
Fourth Level (Test 3)	62%	60%	60%
FEI Junior (Team Test)	—	—	60%
FEI Young Rider (Team Test)	—	—	60%
Prix St. Georges	60%	60%	60%
Intermediate I	60%	60%	60%
Intermediate II	60%	60%	60%
Grand Prix	60%	60%	60%
<b>FREESTYLE</b>	<b>OPEN</b>	<b>AA</b>	<b>JR/YR</b>
First Level	63%	—	—
Second Level	63%	—	—
Third Level	63%	—	—
Fourth Level	63%	—	—
Intermediate I	63%	—	—
Grand Prix	63%	—	—

## 2016 USDF/Dover Saddlery Adult Amateur Medal Program

The USDF/Dover Saddlery Adult Amateur Medal Program is designed to specifically recognize and encourage adult amateurs riding at Second Level.

### Awards

#### 1. USDF/Dover Saddlery Medal Recipient

The eligible rider with the highest score of 60 percent or better in the designated Second Level Test Three class or applicable test of choice USDF/Dover Saddlery Adult Amateur Medal class at a participating competition will receive a handcrafted USDF/Dover Saddlery pewter medal and neck ribbon. Winners will receive a \$20 Dover Saddlery gift certificate for the first three USDF/Dover Saddlery Medals they win during the competition season.

#### 2. USDF/Dover Saddlery National Merit Award

A USDF/Dover Saddlery National Merit Award will be awarded to riders winning three USDF/Dover Saddlery Medals in the same competition year.

#### 3. Year-End Awards

The USDF/Dover Saddlery Medal National Champion and Reserve Champion are determined from the average of the top three winning ride scores during the competition year. The champion receives a \$1000 Dover Saddlery gift certificate and the reserve champion receives a \$500 Dover Saddlery gift certificate.

### Rider Eligibility

1. Rider must have a current USDF Participating or Group Membership and be a member in good standing of USDF when the scores are earned.
2. Rider must be an adult amateur in accordance with Article GR1306 of the USEF rules and be designated with USEF as an adult amateur at the time the scores are earned.

### Owner & Horse Eligibility

1. Horse and owner must meet minimum competition eligibility requirements at the time scores are earned.

### Additional Information

For additional information and an updated list of competitions offering the USDF/Dover Saddlery Adult Amateur Medal Program, please visit <http://www.usdf.org/awards/performance/adultmedalprogram.asp>.

# TRACK POINTS, CLIMB THE STANDINGS, AND EARN YEAR-END AWARDS!



Make your results count toward the USEF Horse of the Year Awards and Silver Stirrup Awards Programs with an annual or lifetime horse recording. Call or email today to speak with a customer care representative about how to get started.

859 258 2472 // [customer@usef.org](mailto:customer@usef.org)



**USDF Membership Benefits:** USDF is dedicated to education, the recognition of achievement, and promotion of dressage. For details on member benefits, including educational programs, awards, and other opportunities, refer to the *USDF Member Guide* or the USDF website at [www.usdf.org](http://www.usdf.org).

**This  
competition  
is recognized  
by USDF  
for 2016**

**Membership Requirements for USEF-licensed/USDF-recognized Competitions:** Owners and riders, including foreign riders and owners who are not residents of the US, wishing to participate in a USEF-licensed/USDF-recognized competition as a rider or owner/lessee, must have either a USDF Group Membership (GM), Participating Membership (PM), or have a USDF Non-Member (NM) identification number and pay the USDF Non-Member (NM) fee. (Note: USDF Business Members can own horses but cannot compete as riders with their USDF Business Membership.) Individuals cannot compete at a USEF-licensed/USDF-recognized competition with a USDF Education Membership.

Horses competing at USEF-licensed/USDF-recognized competitions must have either a USDF Horse Identification (HID) number or a USDF Lifetime Horse Registration (LHR). Proper credentials or verification certificates must be presented to the competition secretary.

Riders and owners wishing to participate in a USEF-licensed/USDF-recognized competition, and not able to present the competition secretary with verification of a USDF membership or NM identification, and USDF LHR or USDF HID, must complete a USDF Competition Affidavit Form and pay the \$5 affidavit filing fee. A copy of a completed affidavit form from another competition may also be used for verification purposes for up to 60 days. (Exception: Affidavits cannot be used at Great American Insurance Group/USDF Regional Dressage Championships.)

**Exceptions:**

- Horses competing only in Individual Breed Classes (IBCs) at DSHB competitions, sires and dams of horses in DSHB group classes, where those sires or dams are not actually competing in the same competition, horses competing only in breed restricted dressage or DSHB classes at Regular Competitions (e.g. all Arabian, all Friesian, or all Morgan classes), or in USDF Introductory Level tests, pas de deux or quadrille, are exempt from this requirement. Also exempt are horses ridden in leadline, exhibitions, games and races, classes for 4-H members, walk-trot, academy and opportunity classes.
- Riders and owners/lessees competing only in classes which are exempt from the USDF HID requirements are also exempt from the USDF NM identification number and NM fee requirements. Also exempt are handlers of horses competing in DSHB In-Hand or Group classes.

**Memberships Defined**

**Participating Membership (PM):** A membership issued to an individual directly by USDF. The membership year is December 1 through November 30. PMs are available for 1-year (\$75), 5-years (\$300), or life (\$1,500). A USDF Youth Participating Membership (YPM) is available for individuals who have not reached their 21<sup>st</sup> birthday by December 1 of the current membership year (\$60). A PM allows the member to compete at USEF-licensed/USDF-recognized competitions and to participate as a rider and/or owner/lessee for all Adequan®/USDF Year-End Awards, Great American Insurance Group/USDF Breeders Championship Series Finals and the Great American Insurance Group/USDF Regional Dressage Championship program.

**Group Membership (GM):** A membership issued to an individual by USDF when the member name and dues are submitted to USDF through an affiliate Group Member Organization (GMO). The GM year begins December 1 and ends November 30. A GM allows the member to compete at USEF-licensed/USDF-recognized competitions and participate in the USDF Rider Awards program.

**Business Membership (BM):** A membership that runs December 1 through November 30 and is issued to a business or organization directly by USDF. The USDF BM (\$200) offers a wider variety of advertising benefits. BMs satisfy requirements of horse ownership only.

**Education Membership (EM):** A membership issued to an individual directly by USDF. This online education only membership expires 12 months after the date joined. This membership type does NOT allow an individual to compete at a USEF-licensed/USDF-recognized competition.

**Non-Member (NM) Identification Number:** For each USDF NM owner/lessee and USDF NM rider there will be a USDF NM fee of \$25 per competition that must be collected by the show secretary and submitted to USDF, along with the USDF Report of Fees document and the \$5 affidavit fee and Competition Affidavit Form if the person cannot provide a copy of their USDF NM card. Owners/lessees or riders exempt from the NM number requirements are also exempt from paying the USDF NM fee. If there are multiple owners of a horse and all are NMs, only one of the owners must pay the NM fee. If the horse has at least one owner who is a current USDF PM, GM, or BM there is no NM fee assessed. Competition management will be invoiced for all applicable USDF NM fees not received with the USDF post competition paperwork, along with a report listing all USDF NMs. Competition management is then required to submit the NM fees within 30 days to the USDF. An individual with a USDF NM identification number is not eligible for any USDF membership benefits. Once a USDF NM number has been assigned, a USDF NM card can be obtained from the USDF website.

**Horse Identification (HID) Number:** A one-time tracking number for horses (\$25). Scores earned by a horse with an HID number will be recorded, but will NOT be counted towards Adequan®/USDF Year-End Awards. A horse with an HID number is not eligible to compete in Great American Insurance Group/USDF Regional qualifying or championship classes or Great American Insurance Group/USDF Breeders Championship Series Finals. An HID number can be upgraded to a Lifetime Horse Registration (LHR) for a fee of \$70. If a horse has a USDF LHR it does not need an HID number. An HID number is a one-time fee that does not need to be renewed.

**Lifetime Horse Registration (LHR):** A horse with an LHR (\$95) is eligible for Adequan®/USDF Year-End Awards, and eligible to compete at Great American Insurance Group/USDF Breeders Championship Series Finals and Great American Insurance Group/USDF Regional qualifying and championship classes, assuming requirements for the owner and rider are met. If a horse has an LHR it does not need an HID number. An LHR does not need to be renewed.

**How to Join USDF**

Applications for USDF Participating Membership (PM), Business Membership (BM), Horse Identification (HID) number, and Lifetime Horse Registration (LHR) may be found in the following locations:

- On the USDF website: [www.usdf.org](http://www.usdf.org). You can submit the application online or download the form and fax or mail it to the USDF office.
- In the show office at USEF-licensed/USDF-recognized competitions classified by USEF as Dressage Competitions, and Regular Competitions which are open to all breeds.
- By calling or writing the USDF office at (859) 971-2277, 4051 Iron Works Parkway, Lexington, KY 40511

The effective date of membership is the date the form and correct fees are received in the USDF office or, if applying at a competition, the date accepted by the competition secretary, provided the application is signed and dated by the competition secretary, member, and/or horse owner on that same day.

# *USDF Statement on Animal Welfare*

The United States Dressage Federation, Inc. (USDF), a federation of over 120 independent organizations throughout the United States with a membership of 30,000 members, supports the concept of ethical treatment of animals.

Dressage is a classical method of training horses, based upon the horse's natural responses, as carried out in a gradual, planned program during which the horse's athletic abilities are improved in a systematic manner. As a result, the horse becomes capable, comfortable, and responsive in partnership with the rider without the use of force. Dressage competition at various levels of achievement is the ultimate test of the training program to determine whether the desired harmony between horse and rider has been achieved.

The rules pertaining to dressage competition prohibit the use of artificial appliances, training aids, and drugs, which would force the horse to submit. Instead, the emphasis is upon training and a cooperative partnership with the rider. Major competitions are carefully monitored to assure that there is no unnecessary force or harshness displayed.

Unlike other horse sports in which horses enter training at a relatively immature state, dressage training is usually not seriously begun until the horse is three or four. The top levels of achievement require five or more years of progressive training and it is not unusual to see horses in international competition in their late teens. This, in itself, places a premium on good care and soundness throughout the horse's life.

While supporting the concept of animal welfare in its broadest form, the United States Dressage Federation, Inc., also recognizes that it is unrealistic to ascribe human emotions and responses to the horse which in its wild state is a creature of flight, living a hard and precarious existence. Under domestication, the horse is assured of ample food, water, and shelter, as well as protection against infectious diseases and damaging parasites, thus leading a longer and healthier life with a high rate of survival.

As an educational organization, USDF has numerous programs, which teach people how to pursue the accepted, humane training methods. A program of certifying instructors also emphasizes protecting the horse's welfare in pursuit of dressage training.

United States Dressage Federation  
4051 Iron Works Parkway, Lexington, KY 40511  
Phone: 859-971-2277, Fax: 859-971-7722, [usdressage@usdf.org](mailto:usdressage@usdf.org), [www.usdf.org](http://www.usdf.org)

# 2016 DRESSAGE COMPETITION ENTRY FORM

Effective December 1, 2015, use this form for entering USEF/USDF Licensed Dressage Competitions held in USDF Region 1 (PA, NJ, DE, MD, VA, NC, WV)

Competitors are responsible for duplicating their own additional copies of this entry form. This is a 2-sided form; please make 2-sided copies. Other versions of entry forms may not be accepted by Region 1 competitions. TYPE OR PRINT CLEARLY -- ONLY ONE HORSE / RIDER or HANDLER PER ENTRY FORM

Enclose copy of all 2016 USEF Membership Cards (Rider/Handler, Owner/Agent, Trainer, Coach) or verification.

Official Use Only	Bridle No.
-------------------	------------

Competition Name: \_\_\_\_\_ Competition Date(s): \_\_\_\_\_

NAME OF HORSE (Horse MUST be named)	BREED	COUNTRY (Where Bred)	SEX	HEIGHT	COLOR	AGE	DOB
Date of Coggins (must attach copy):		Breed Registration Number:		Check here if this horse is for sale and you want this to be listed in the Program _____			
Sire:		Dam:		Dam's Sire:			
For Dressage Sport Horse Breeding (DSHB) classes, Sire, Dam, Dam's Sire & Breeder names required for ALL breed registered horses & recommended for others.			Breeder:				

Rider/Handler: \_\_\_\_\_ Primary Phone: \_\_\_\_\_ Alternate Phone: \_\_\_\_\_

Rider's Address: \_\_\_\_\_

Rider/Handler E-Mail: \_\_\_\_\_ Citizenship\*: \_\_\_\_\_

Owner: \_\_\_\_\_ Primary Phone: \_\_\_\_\_ Alternate Phone: \_\_\_\_\_

Owner's Address: \_\_\_\_\_ E-Mail: \_\_\_\_\_

Trainer: \_\_\_\_\_ Trainer's Address: \_\_\_\_\_

Coach: \_\_\_\_\_ Trainer's Phone during Competition: \_\_\_\_\_

HORSE	RIDER/HANDLER	OWNER (At least one)	TRAINER	COACH (if applicable)
USEF#	USEF#	USEF#	USEF#	USEF#
USDF#	USDF#	USDF#		
LOCAL ASSN #		All USEF members (including riders, handlers, trainers, coaches, owners, agents or lessees) are required to submit proper membership documentation to the show secretary prior to competing. Exhibitors who do not send a copy of their card with their entry or are unable to produce the card when registering at the competition, or for whom the competition cannot verify such information (with the exception of Federation measurement cards) will be required to pay a \$30 Show Pass fee which is non-refundable. EACH Junior and Senior participant (rider, handler, trainer, coach and one owner/agent per horse) is required to be a USEF Active "Competing" Member or pay a \$30 Show Pass fee (see the official USEF Show Pass Statement in prize list). Non-U.S. citizen participants in Dressage/DSHB classes MUST attach current proof, in English, of current membership in good standing in their own N.F. in order to be exempt from USEF Show Pass fees.		
<i>Unless show provides entry verification service:</i> * MUST attach copies of USEF & USDF Horse Recording and Registration Certificates for GAIG/USDF Qualifying and Championship Classes. * MUST include a copy of USEF Amateur Certification if competing as an Adult Amateur. Go to <a href="http://www.eqverification.org/">http://www.eqverification.org/</a> to print copies.				

Class #	Day	Class Name (Level//Division/Test - if TOC)	GAIG Fee	Fee	Payment For	Fee	Office Use
					Subtotal, Class Fees		
					USEF Show Pass/Non-Member Fee(s) (\$30 per participant)		
					USEF Fee per horse: (D&M \$8+ USEF \$8) = \$16		
					CDI horses only: USEF Fee per horse: (D&M \$20 + USEF \$8) = \$28		
					CDIs only: USEF IHP Discipline Fee (\$35 per entry)		
					Stabling / Grounds Fee (For Non-Stabled Horses)		
					USDF Non-Member Fee(s) (\$25 per rider/owner)		
					Office Fee		
					Late Fee, Bridle Number Fee, Camper Fee		
					Other Fee(s)		
<b>SUBTOTAL Class Fees</b>							

JR or YR Birthdate: \_\_\_\_\_ Riders are eligible to compete as a Jr/YR until the end of the calendar year in which they reach the age of 21

**TOTAL FEES DUE:** \_\_\_\_\_

CDI / CDI-Y/ CDI-J/ CDI-P COMPETITORS MUST COMPLETE THE FOLLOWING INFORMATION:			
Rider:	Citizenship:	FEI Rider Registration #:	Competing for Country:
Horse:	Present Nationality:	Birthdate:	Previous Name (if any):
	FEI Passport #:	FEI Horse Registration #:	Person Responsible:
Owner:	Citizenship:	Owner Social Security or Tax ID # (required to receive prize money):	

**US Equestrian Federation, Inc. Entry Agreement** I have read the United States Equestrian Federation, Inc. (the "Federation") Entry Agreement (GR906.4) as printed in the Prize List for [insert name here] ("Competition") and agree to all of its provisions. I understand and agree that by entering this Competition, I am subject to Federation Rules, the Prize List, and local rules of the competition. I agree to waive the right to the use of my photos from the competition, and agree that any actions against the Federation must be brought in New York State.

**Federation Release, Assumption of Risk, Waiver and Indemnification** *This document waives important legal rights. Read it carefully before signing.* I AGREE in consideration for my participation in this Competition to the following: I AGREE that "the Federation" and "Competition" as used herein includes the Licensee and Competition Management, as well as all of their officials, officers, directors, employees, agents, personnel, volunteers and Federation affiliates. I AGREE that I choose to participate voluntarily in the Competition with my horse, as a rider, driver, handler, vaulter, longeur, lessee, owner, agent, coach, trainer, or as parent or guardian of a junior exhibitor. I am fully aware and acknowledge that horse sports and the Competition involve inherent dangerous risks of accident, loss, and serious bodily injury including broken bones, head injuries, trauma, pain, suffering, or death. ("Harm"). I AGREE to hold harmless and release the Federation and the Competition from all claims for money damages or otherwise for any Harm to me or my horse and for any Harm of any nature caused by me or my horse to others, even if the Harm arises or results, directly or indirectly, from the negligence of the Federation or the Competition. I AGREE to expressly assume all risks of Harm to me or my horse, including Harm resulting from the negligence of the Federation or the Competition. I AGREE to indemnify (that is, to pay any losses, damages, or costs incurred by) the Federation and the Competition and to hold them harmless with respect to claims for Harm to me or my horse, and for claims made by others for any Harm caused by me or my horse while at the Competition. I have read the Federation Rules about protective equipment, including GR801 and, if applicable, EV114, and I understand that I am entitled to wear protective equipment without penalty, and I acknowledge that the Federation strongly encourages me to do so while WARNING that no protective equipment can guard against all injuries. If I am a parent or guardian of a junior exhibitor, I consent to the child's participation and AGREE to all of the above provisions and AGREE to assume all of the obligations of this Release on the child's behalf. I represent that I have the requisite training, coaching and abilities to safely compete in this competition. I AGREE that if I am injured at this competition, the medical personnel treating my injuries may provide information on my injury and treatment to the Federation on the official USEF accident/injury report form. BY SIGNING BELOW, I AGREE to be bound by all applicable Federation Rules and all terms and provisions of this entry blank and all terms and provisions of this Prize List. If I am signing and submitting this Agreement electronically, I acknowledge that my electronic signature shall have the same validity, force and effect as if I affixed my signature by my own hand. *BOD 1/23/11 Effective 12/1/11*

*RIDER/HANDLER (mandatory)	*OWNER / AGENT (mandatory)	*TRAINER (mandatory)	COACH (if applicable)
Signature:	Signature:	Signature (must be 18 or older):	Signature:
Print:	Print:	Print:	Print:
PARENT/GUARDIAN (Required if rider/handler is a minor, i.e. under 18)		(Home/Parent) Emergency Contact Phone #	Is RIDER a U.S. citizen? (mandatory)
Signature:	Print:		YES _____ NO _____

*\* No entry is valid without original signatures from the above individuals; Photocopied signatures or writing "same" are NOT acceptable.*

STABLING / CAMPER HOOK-UP RESERVATION FORM (Refer to Prize List for Specifications)									
Contact NAME and NUMBER for Rider Emergency:					Contact NAME and NUMBER for Horse Emergency:				
_____ / _____					_____ / _____				
Name of Lodgings Where Rider or Responsible Party Will be Staying During the Competition					Hotel Number at the Competition (For Emergency Contact Purposes)				
Stall Occupant	Sex (S,M,G)	Check Stall Days/Nights Desired (see prize list directives)							
		Mon	Tues	Wed	Thurs	Fri	Sat	Sun	
Horse Name									
If accompanied by NON-COMPETING HORSE, must complete separate entry form and pay all applicable fees.									
Tack	n/a								
Approx. Time of Arrival: _____					Approx. Time of Departure: _____				
Special Requests*: _____									
*Provide name of individual with whom you desire to be stabled (if part of a group, make sure you all name the same person)									
Stabling fees: _____ stalls for _____ nights @ \$ _____ per night = _____									
Camper fees _____ hook-ups @ \$ _____ ea (flat rate) OR _____ nights @ \$ _____ per night = _____									
TOTAL STABLING / CAMPER HOOK-UP FEES: _____									

ENTRY PREPARATION CHECKLIST
<i>Before Mailing, Be Sure You Have:</i>
___ Completed Both Sides of Entry Form
___ All Original Required Signatures
___ Enclosed a Copy of the Current Negative Coggins (EIA) Certificate (Refer to Show Specifications for Date Validity Requirements. Copy must be legible.)
___ Supplied all Required Ass'n Numbers
___ Enclosed Copies of Applicable USEF and/or USDF Cards or Documents
___ Completed the Stabling / Camper
___ Enclosed a Check / Money Order for all Applicable Fees.
___ Attached photocopy of Test(s) verifying USDF & FEI Freestyle Test eligibility (ex. for exempt classes)
Mail this Entry Form, Supplemental Documents, and Fees to the Competition (Entry) Secretary Identified on the Prize List.
<b>EMERGENCY CELL CONTACT # OF SOMEONE WITH YOU /YOUR GROUP AT THIS SHOW WHO IS NOT LISTED ELSEWHERE ON THIS ENTRY FORM</b>
_____

**PLEASE SUBMIT ANY IMPORTANT INFORMATION FOR THE ANNOUNCER ON A SEPARATE SHEET**